

# arm

## wire free solutions

ARM Nurse Call 2000 has been developed over several years with both the client and user in mind. It enables staff to efficiently answer calls, making the management of resources more flexible and provides the functionality you would expect of any Nurse Call system.

Providing up to six levels of call and fully descriptive text displays the system is fully supervised. The regular transmissions between the individual units and the system ensure continuous monitoring of the system's functionality. The system is easily installed with radio communication between both the units and the system infrastructure. Unique factory set device identities allow for modular design and installation. System programming can be achieved using a simple computer keyboard and the on-screen menus.

Adaptive technology devices can be easily linked to the Nurse Call system, such as epilepsy, enuresis or movement sensors. These devices raise an automated call which is an ideal solution that offers reassurance to both users & staff.

Once a device is operated, the LED on the unit will flash and a comfort tone is generated to inform the user that their call has been sent to the system and staff have been alerted.

The full text display provides information detailing the identity of the call and its type on all the system displays. These displays can be zoned to provide information to given areas and have a separate and distinct Day and Night mode for user and client comfort. Each call is scrolled on the display with higher status calls taking priority.

The displays can be enhanced or replaced by utilising a fully integrated DECT telephony system or radio paging system. Through more detailed programming both the telephony and paging options can be zoned.

Providing specific call types or locations to individuals or groups ensures those who need to know, receive information quickly and clearly.



The display and telephony options can also be enhanced by the addition of a time and date stamped printer or computer interface for permanent recording.

The system provides for a comprehensive range of call units covering all aspects with simple interface options to provide inputs for more requirements.

WEB: [www.universalradiohire.co.uk](http://www.universalradiohire.co.uk)  
Email: [info@bleeperltd.co.uk](mailto:info@bleeperltd.co.uk)

  
**BLEEPER**  
SERVICES

**Nurse Call 2000**

  
wire free solutions

Nurse Call 2000

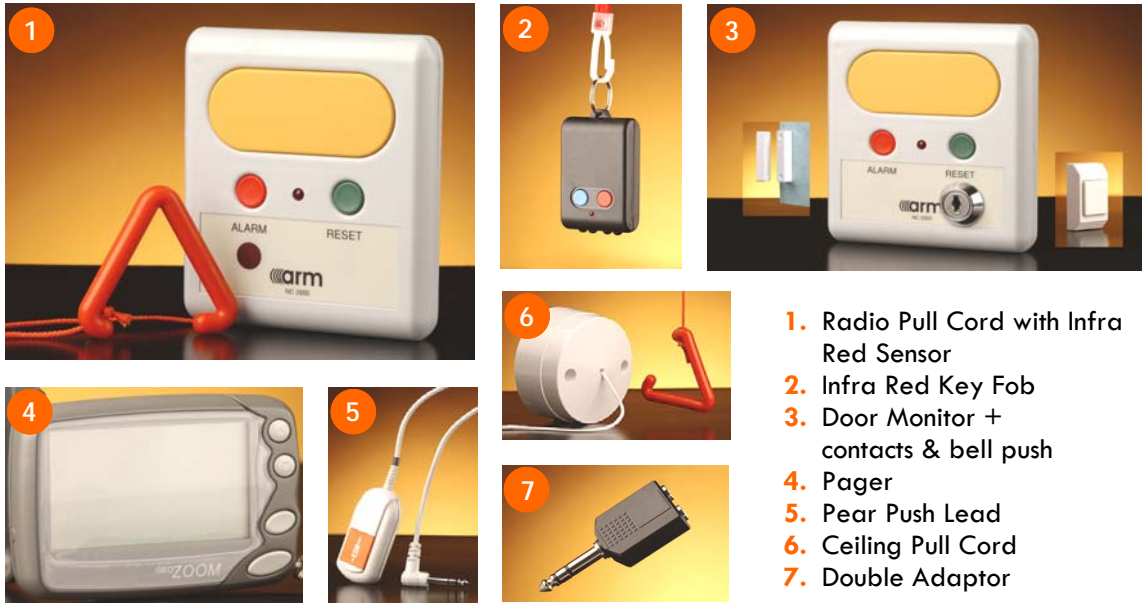

1. Radio Pull Cord with Infra Red Sensor
2. Infra Red Key Fob
3. Door Monitor + contacts & bell push
4. Pager
5. Pear Push Lead
6. Ceiling Pull Cord
7. Double Adaptor

### Call Units

Fully monitored with auto reporting of faults to the control panel. 3.6v lithium battery powered, designed to give a life expectancy up to 3 years, with a warning of low battery condition to give 30 days normal use before failure occurs.

Each call unit provides a visible and audible tone during activation. Calls can only be cancelled from originating unit.

**Call Levels: Emergency, Staff Call, Patient Call, Presence, Jack Removed, Reset**  
Each Level programmable to give plain English text message, type of call, date & time.

### Technical Specification:

- Fully supervised monitoring, with auto reporting of faults to control panel, conforming to EN50131 & PD6662
- Factory set unit identity conforming to EN50131 & PD6662
- System Frequencies 173.225MHz, 868.300MHz and 953MHz
- Effective radiated power: 10mW integral aerial, approved to ETSI EN 300 220-1 & EN 300 220-2 (licence exempt)

### Control Panel:

**System Size:** Up to 64 control panels and 3,000 sensors per system  
**Outputs:** RS232 port for paging system. Selectable DECT or paging protocols  
 RS232 port for system printer  
 RS232 port for computer interface  
 2 programmable fully monitored outputs  
 2 programmable fully auxiliary relays  
**Inputs:** 2 programmable hardwired alarm inputs  
**Display:** Backlit LCD display with 2 lines of 20 characters, giving plain English text messages  
**Event Log Storage:** 2 x 500 events maximum  
**Supply:** Mains: 240V 50Hz 75VA maximum or equivalents  
 Battery: 12V internal re-chargeable giving up to 24 hours standby

In pursuance of a policy of continued improvement, the company reserves the right to change the design and specification without prior notice

WEB: [www.universalradiohire.co.uk](http://www.universalradiohire.co.uk)  
 Email: [info@bleeperltd.co.uk](mailto:info@bleeperltd.co.uk)



## Nurse Call 2000

Alarm Radio Monitoring Ltd  
 Brunel Road  
 Enterprise Park  
 Leominster  
 HR6 0LX

Tel: 01568 610016  
 Fax: 01568 615511

**E-mail:**  
[sales@arm.uk.com](mailto:sales@arm.uk.com)

**Website:**  
[www.arm.uk.com](http://www.arm.uk.com)